



Punga Cove



Trade Manual
1 May 2023 – 30 September 2024





Punga Cove

Punga Cove	3
Welcome to Punga Cove	5
A relaxing natural New Zealand destination	5
Getting here	7
Retail tariffs	9
Dining at Punga	11
Onsite activities	12
Offsite activities	12
Accommodation	14
Punga Cove details	19
Terms	21
Marketing details	23
Property map	24
Lodge location	25
Marlborough location	26





Welcome to Punga Cove

Set amongst stunning scenery in the magnificent Marlborough Sounds, Punga Cove is the perfect retreat, surrounded by nature.

Getting here is easy - by boat from Picton, by foot or bike on the Queen Charlotte Track, or by scenic drive. And, once you're here you can choose to relax and enjoy the many views, or partake in the wide range of land and water-based activities on offer.

A relaxing natural New Zealand destination

Whether you're walking or biking the Queen Charlotte Track, wanting to relax in paradise, looking for a family-friendly or romantic getaway, organising a special occasion or work event, or seeking an action-packed holiday, Punga Cove is perfect for you.

Choose to relax and enjoy the amazing views, or explore using the range of land and water-based activities on offer.

Our rooms offer a range of options, from stylish suites, spacious studios and retro chalets or our larger apartments for families and groups.

You won't go hungry at Punga Cove – with relaxed waterside dining at the Boatshed Café & Bar and smart casual dining at the Punga Fern hilltop restaurant.



Trade bookings: +64 3 579 8561

trade@pungacove.co.nz

www.pungacove.co.nz



Getting here

Punga Cove is accessible by boat from Picton, on foot or bike on the Queen Charlotte, or by road:

Scheduled transfer

Cougar Line scheduled transfer times vary from approximately 60-90 minutes of scenic cruise through the Marlborough Sounds:

Scheduled departures from Picton (Oct-Apr):

8am, 10am & 1.30pm daily; 6pm Fridays (Oct-Nov & Mar-Apr), 6pm daily (Dec-Apr)

Scheduled departures from Picton (May-Sept):

9am & 1.30pm daily; 5.30pm Fridays

Scheduled departures from Punga Cove (Oct-Apr):

9.45am, 11.45am, 3.15pm & 7.15pm

Scheduled departures from Punga Cove (May-Sept):

10.45am, 3.15pm daily; 7pm Fridays

Private transfer

60 mins from Picton by Cougar Line scenic water taxi.

Queen Charlotte Track

3-4 hour walk from Furneaux Lodge. Cougar Line operates daily water transfers from Picton to the start of the Queen Charlotte Track at Ship Cove, and to Furneaux Lodge for shorter walks.

Road

Travel by road is not recommended as a large amount of road is unsealed.

You can fly direct to Marlborough Airport in Blenheim from Auckland and Wellington. It's a 30 minute drive to Picton from the airport. Airport transfers are available through Marlborough Tour Company.

Other ways of getting to Picton include driving from Christchurch, Nelson and the West Coast, taking a ferry into Picton or Sounds Air flight into Koromiko Airport from Wellington, or direct helicopter transfers from Wellington, Blenheim and Nelson.





Retail tariffs

Rates are for two people double or twin share and include:

- Tea & coffee facilities
- Wi-Fi use – generally available in jetty/bar area
- GST (New Zealand Goods & Services Tax)

Room-only rate for two guests

	Avail	Pax	Sqm	Bedrooms	Off Peak	Peak	High Peak
Frond Suite	5	2	42-48	1 bedroom: King split	\$320	\$390	\$420
Fern Studio	2	2	31	Studio: King split	\$300	\$370	\$400
Koru Chalet	5	2	22	Studio: Queen	\$230	\$310	\$330
Mamaku Apartment*	3	4-7	45-97	2-3 bedrooms: King split/Queen + singles	\$420	\$490	\$520

* Mamaku Apartment tariff is for four guests. Charge for additional guests in apartments is \$80 per person per night, children 5-15 is \$40, children aged 0-4 years are free when staying with a paying guest. Rates are gross commissionable and include New Zealand Goods & Services Tax (GST). Prices are effective from 1 May 2023, but are subject to change.

Seasons:

Off Peak

1 May – 31 Oct 2023

Peak

1 Nov – 21 Dec 2023

15 Jan – 30 April 2024

High Peak

22 Dec 2023 – 14 Jan

2024

Water transfers:

Cougar Line scheduled return water transfers - Adults: \$70pp one way/\$110pp return; Children (5-15 years): \$35pp one way/\$54.50pp return (0-4 years are free). Water transfers can be arranged directly with Punga Cove at time of reservation.

Option for private scenic water taxi with Cougar Line (approx 50-60 minutes) – please enquire for pricing.

Public holiday surcharges:

Punga Cove does not apply public holiday surcharges to its pricing.



Food tariffs

Food rates are net prices (GST inclusive, non-commissionable).

Full Breakfast

a la carte	\$27
------------	------

Packed lunch (Perfect for the hiker or offsite adventure)

Sandwich with choice of filling, homemade baking, fruit, and juice or water.	\$29
--	------

Dinner

2 course a la carte	\$65
3 course a la carte	\$75

Dining at Punga

You won't go hungry at Punga Cove, with a café/bar and restaurant on-site.



The Boatshed bar and café at the jetty serves a casual menu for lunch and dinner. Enjoy the best pizzas in the Marlborough Sounds, stunning seafoods, craft beer and Marlborough wine, all right on the waterfront



The Punga Fern hilltop restaurant offers smart casual dining featuring the best of local Marlborough produce, paired with Marlborough and international wines. All this while taking in arguably the best view in the Marlborough Sounds.

If you're walking or biking the Queen Charlotte Track or simply heading out for a day trip, we offer packed lunches.

- Rooms feature coffee and tea facilities, with a mini fridge.
- For guests heading out for the day, we offer delicious packed lunches.
- Head to lunch at Furneaux Lodge, our sister lodge, across the inlet (walk to Furneaux Lodge in the morning – 3-4 hour walk – enjoy fresh local cuisine, and catch the afternoon Cougar Line service back to Punga Cove).



Onsite activities

Included in the tariff

- Kayaks
- Paddle boards (SUPs)
- Open air swimming pool (unheated)
- Spa pools
- Wi-Fi (near the Boatshed Café & Bar)

Or simply relax and enjoy the views, native forest and birdlife from your balcony or alongside the pool, spa and beach.

Nearby walks include:

- Furneaux Lodge – 3-4 hours one way, 11km flat walk, lunch and bar snack menu at restaurant, option to catch Cougar Line boat back.
- Eatwell's Lookout – 4 hours return, medium grade on well maintained Queen Charlotte Track. A track pass (available for purchase from Punga Cove) is required for this section of the track.
- Mt Stokes – 5km drive then 3.5 hours return hike; a steep climb to the top of the tallest point in the Marlborough Sounds, offering spectacular views.
- Punga Loop – 45 min walk via Camp Bay, up to Kenepuru Saddle and back down road to Punga Cove.

Offsite activities

Available on request, additional charges apply

A range of land and water-based activities allow you to explore the local area, including:

- Walk-lunch-boat: Walk to Furneaux Lodge across the inlet (11km, 3-4 hours walk), have lunch and catch the scheduled afternoon Cougar Line boat back to Punga Cove.
- Boat-lunch-boat: Catch the scheduled morning Cougar Line boat, cruise through the Marlborough Sounds to Picton, enjoy lunch or a wander of the shops, then board the 1.30pm Cougar Line for a leisurely boat ride back to the lodge.
- Charter your own cruise – explore Motuara Island bird sanctuary, historic Ship Cove/Meretoto, local aquaculture farms, and more.
- Bike a section of the Queen Charlotte Track – 2 hours to Furneaux Lodge for lunch or a drink (bike hire is available by advance booking).





Accommodation

FronD Suites (5 available)



Suite bedroom

- One bedroom
- 42-48sqm
- Max 2 guests
- King split beds – king or twin options (plus, rollaway bed & cot options)
- Ensuite bathroom with shower
- Air conditioning/heat pump
- Mini fridge & tea/coffee making facilities
- Deck with water views



Suite bedroom & view

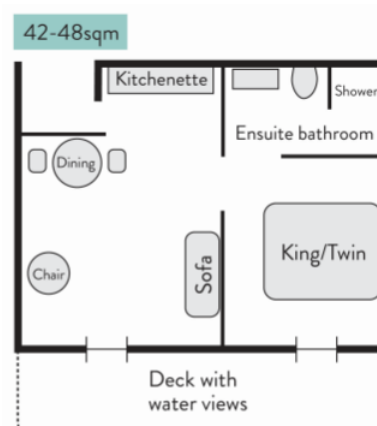

Room-only rate for two guests

	Avail	Pax	Sqm	Bedrooms	Off Peak	Peak	High Peak
FronD Suite	5	2	42-48	1 bedroom: King split	\$320	\$390	\$420

Rates are gross commissionable and include New Zealand Goods & Services Tax (GST). Prices are effective from 1 May 2023, but are subject to change.

Fern Studios (2 available)



Studio lounge area & deck



Studio deck

- Studio
- 31 sqm
- Max 2 guests
- King split beds – king or twin options (plus, rollaway bed & cot options)
- Ensuite bathroom with shower
- Air conditioning/heat pump
- Mini fridge & tea/coffee making facilities
- Deck with water views

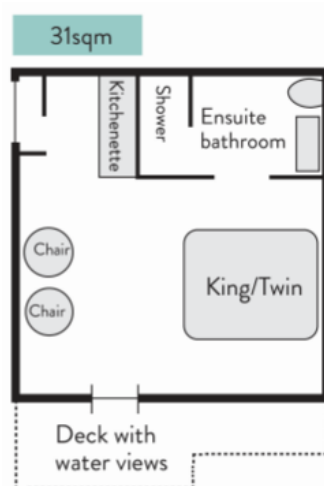

Room-only rate for two guests

	Avail	Pax	Sqm	Bedrooms	Off Peak	Peak	High Peak
Fern Studio	2	2	31	1 bedroom: King split	\$300	\$370	\$400

Rates are gross commissionable and include New Zealand Goods & Services Tax (GST). Prices are effective from 1 May 2023, but are subject to change.

Koru Chalets (5 available)



Chalet studio bedroom



Chalet deck

- Studio
- 22 sqm
- Max 2 guests (cots available on request)
- Queen bed
- Ensuite bathroom with shower
- Mini fridge & tea/coffee making facilities
- Wall heater
- Deck with water views

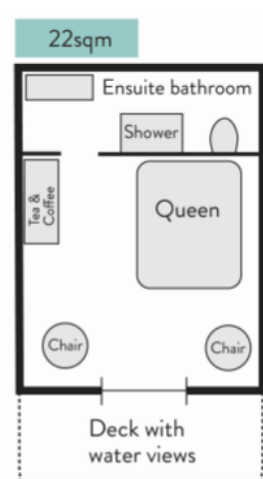

Room-only rate for two guests

	Avail	Pax	Sqm	Bedrooms	Off Peak	Peak	High Peak
Koru Chalet	5	2	22	1 bedroom: Queen	\$230	\$310	\$330

Rates are gross commissionable and include New Zealand Goods & Services Tax (GST). Prices are effective from 1 May 2023, but are subject to change.

Mamaku Apartments (3 available)

A range of multi-bedroom apartments, of different configurations, each with a deck with water views, mini fridge and tea/coffee making facilities. Rollaway bed & cot available.

Room 10

- 2 bedrooms
- 97 sqm
- Max 4 guests
- King split x2
- Air conditioning/heat pump
- Bathroom with shower and spa bath

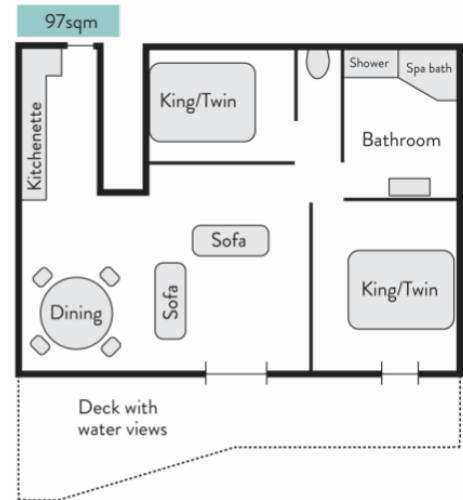

Room 10 dining



Room 10 lounge

Room 11

- 3 bedrooms (inc loft)
- 57 sqm
- Max 7 guests
- King split x2 + 3x trundle singles in loft
- Wall heaters
- Bathroom with shower and spa bath

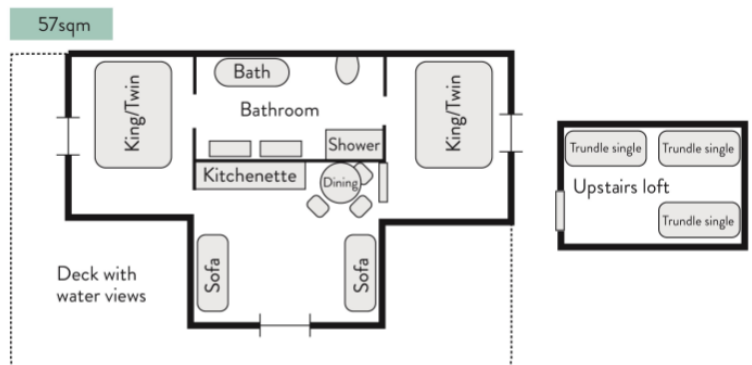

Room 11 bedroom



Room 11

Room 17

- 2 bedrooms (note master open plan to lounge – no door)
- 45 sqm
- Max 4 guests
- King split – twin option + 2x singles
- Air conditioning/heat pump
- Bathroom with shower

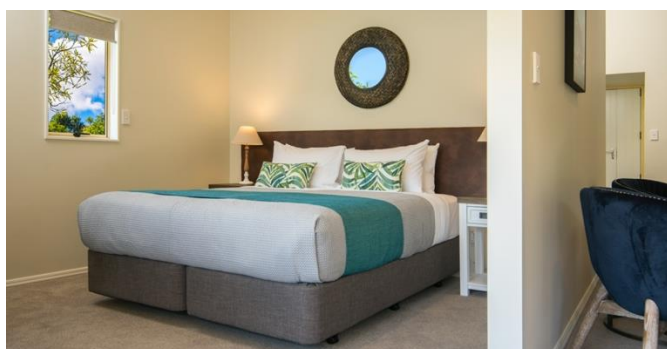
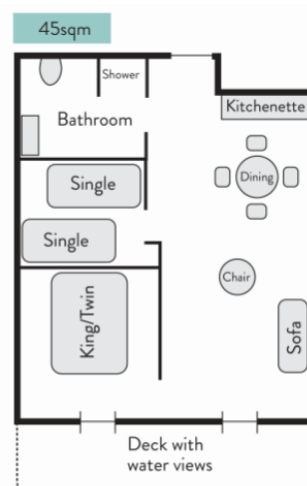

Room 17 bedroom



Room 17 lounge & deck

Room-only rate for four guests

	Avail	Pax	Sqm	Bedrooms	Off Peak	Peak	High Peak
Mamaku Apartment	3	4-7	45-97	2-3 bedrooms: King Split/ Queen + Singles	\$420	\$490	\$520

* Charge for additional guests in apartments is \$80 per person per night, children 5-15 is \$40, children aged 0-4 years are free when staying with a paying adult. Rates are gross commissionable and include New Zealand Goods & Services Tax (GST). Prices are effective from 1 May 2023, but are subject to change.



Punga Cove details

Check-in/out

- Check-in is available from 3pm – guests are welcome to ask if early check-in is available on arrival.
- Check-out is available until 10am. Late check out may be available – guests are welcome to request this during their stay.

Child policy

Children of all ages are welcome at Punga Cove:

- Child rates apply to children 5-15 years.
- Children 0-4 years stay free at Punga Cove (food and beverages are charged).

High peak dates

Because our Christmas/New Year period is highly popular, we have premium rates over this time.



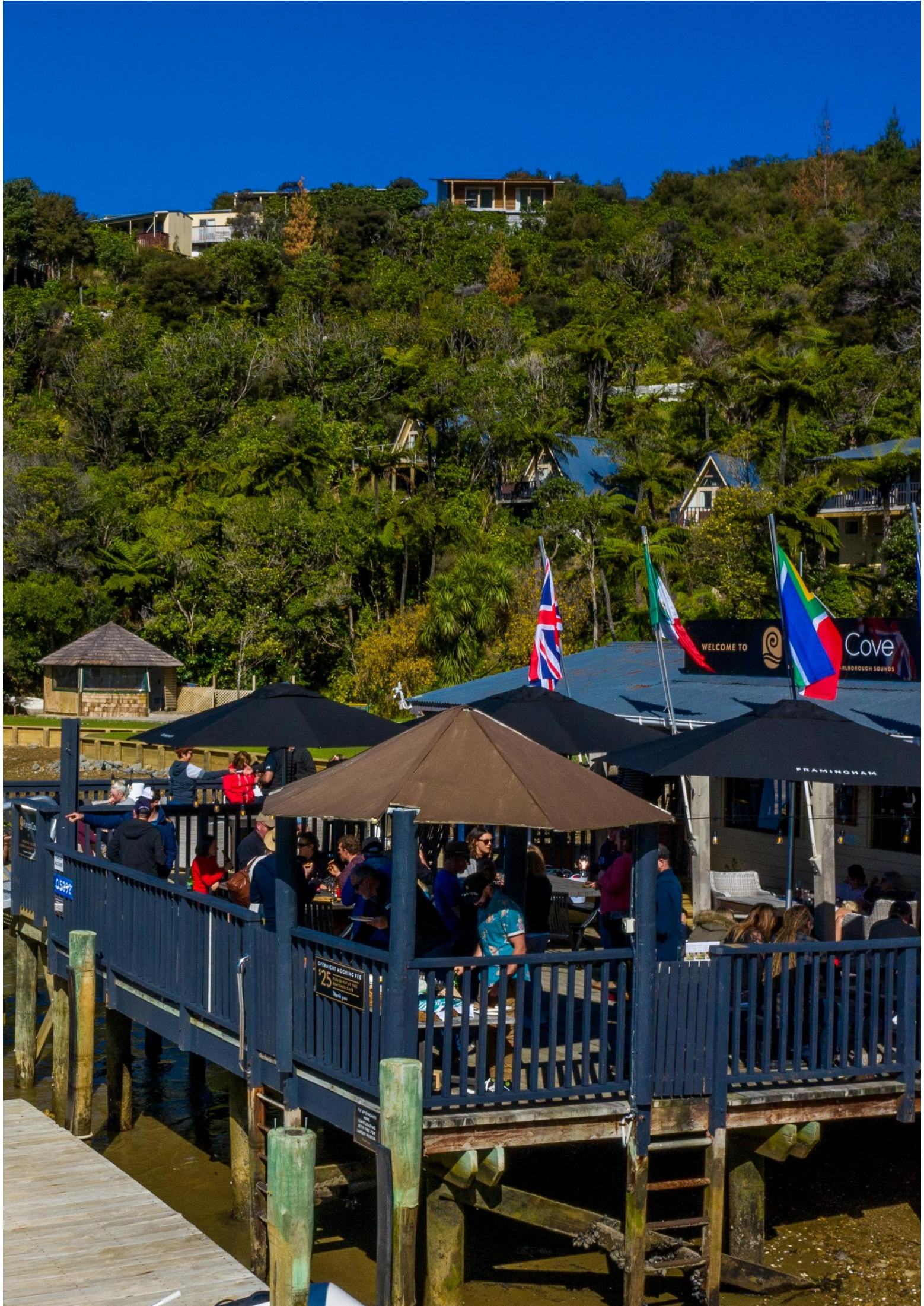

Terms

Booking terms

Terms apply to companies who have a credit account with Punga Cove or Marlborough Tour Company Group.

Rooms may be 'held' at no charge for a maximum of 10 working days and then must be confirmed or released.

For those without a credit account in place, a 20% deposit is required to be paid at the time of booking with full payment to be made 7 days before the commencement of the booking.

Cancellation policy

8+ days prior to arrival	No charge/full refund* if prepaid
7 days – 2 days prior to arrival	Free transfer to another date within a 12-month period, or 100% tariff charge
Within 2 days prior to arrival	100% tariff charge

Cancellation policy – Group bookings (5 rooms or more)

30+ days prior to arrival	No charge/full refund* if prepaid
7-30 days prior to arrival	Free transfer to another date within a 12-month period, or 50% tariff charge
1-6 days prior to arrival	100% tariff charge

*Refunds are processed within 5 business days

Cancellations due to Government-imposed travel bans

If your travel plans are interrupted due to Government-imposed travel bans or border closures, you are welcome to transfer your booking to a later date within the next 12 months with no transfer fee. Depending on room type availability and intended travel season, differences in room rate or room type may apply as at the date of rebooking. Otherwise our standard cancellation policy applies.

Cancellations by Punga Cove and Marlborough Tour Company

Punga Cove and Marlborough Tour Company reserve the right to reschedule or cancel any tours, cruises and accommodation booked if it feels that they cannot be undertaken safely, e.g. bad weather conditions. In the event of Punga Cove or Marlborough Tour Company making a cancellation you will be offered an alternate date or option, or receive a full refund.

All transactions are in New Zealand dollars at the time of making a booking and at the time of making a cancellation; Punga Cove and Marlborough Tour Company Group cannot accept any liability for fluctuation in exchange rates between these transactions taking place.



Banking details

Punga Cove

Bank Account Marlborough Tour Company
ANZ Bank
06-0601-0742421-01

Swift Code ANZBNZ22

GST number 57-785-081

Punga Cove accounts contact: accounts@marlboroughtourcompany.co.nz

Contact details

Trade contact res@marlboroughtourcompany.co.nz
Ph +64 3 577 9997

Physical address Endeavour Inlet,
Queen Charlotte Sound,
Marlborough Sounds
New Zealand

Road address for Emergency calls: Akerbloms Road

Postal address PO Box 1000,
Blenheim,
Marlborough,
New Zealand

Lodge phone +64 3 579 8561

Lodge email res@marlboroughtourcompany.co.nz

Website www.pungacove.co.nz



Marketing details

Punga Cove is owned and operated by Marlborough Tour Company.

We have a range of still images and videos available for promotional use.

Online image library - SmugMug <https://marlboroughtourcompany.smugmug.com/Marlborough-Sounds-Accommodation/Punga-Cove/>

Punga Cove video - SmugMug <https://marlboroughtourcompany.smugmug.com/Marlborough-Sounds-Accommodation/Punga-Cove/Videos>

Punga Cove video – YouTube https://youtu.be/_kFT_PWtZE

Punga Cove video - Vimeo <https://vimeo.com/352555155>

Marlborough Tour Company YouTube channel www.youtube.com/channel/UC_qexf8PaQnww6rZ6uN5pqg

Marketing contact trade@pungacove.co.nz



Property map

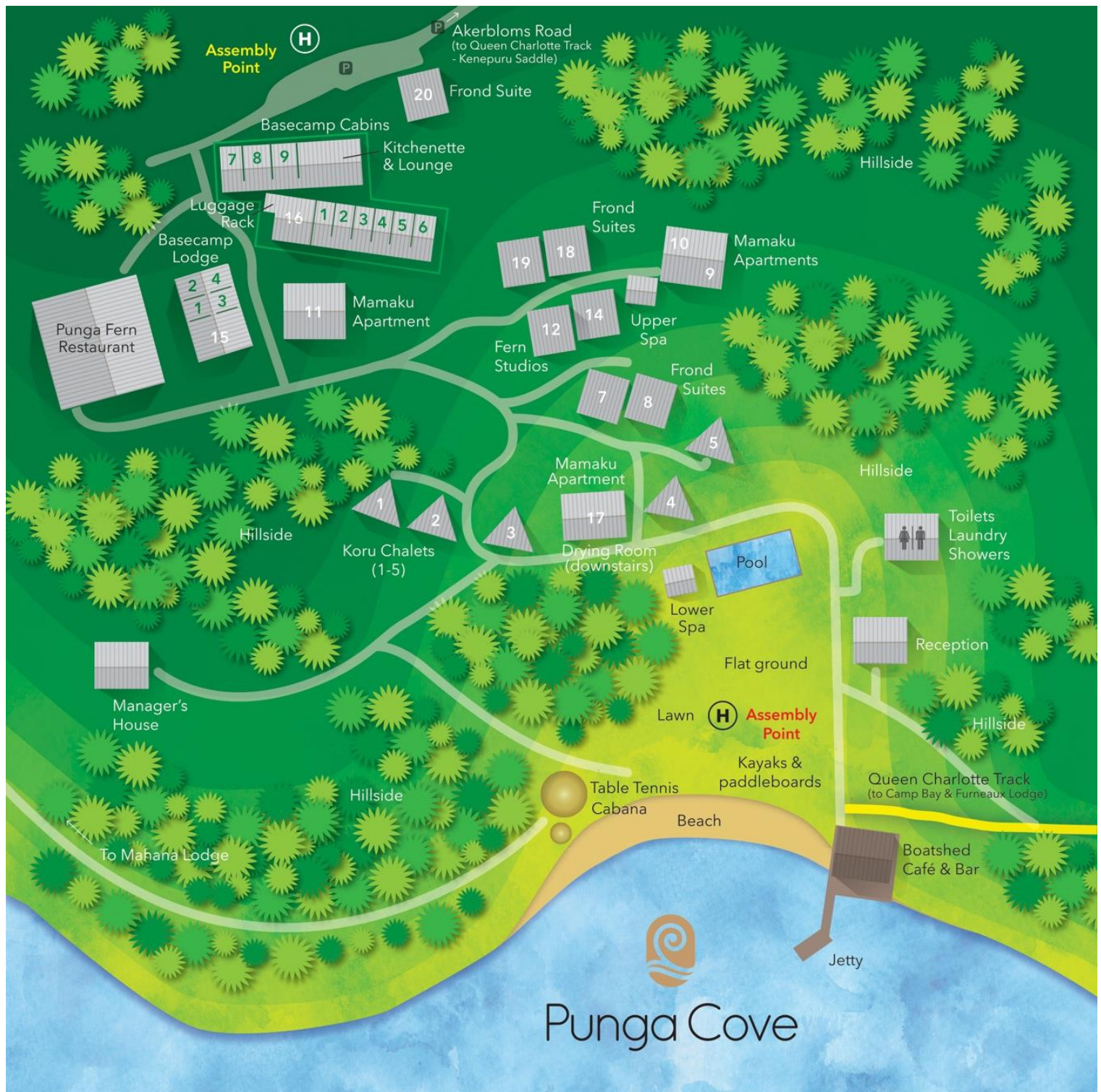

Lodge location

Punga Cove is 50-60 minutes from Picton by direct water taxi or 90 minutes on a scheduled scenic sailing.



Marlborough location

Marlborough is centrally located in New Zealand and Marlborough Airport in Blenheim is a short flight from Auckland or Wellington – with a half hour drive to Picton where you can board a Cougar Line boat. It is also a three-hour ferry ride from Wellington or you can drive from Nelson or Christchurch.

